

NOTE:  
 BOTTOM LAYER OF INSULATION SHALL BE LAID DOWN IN  
 A STAGGERED PROFILE. STAGGER AND OFFSET TOP LAYER  
 OF INSULATION FROM BOTTOM LAYER TO PREVENT  
 ALIGNED EDGES.

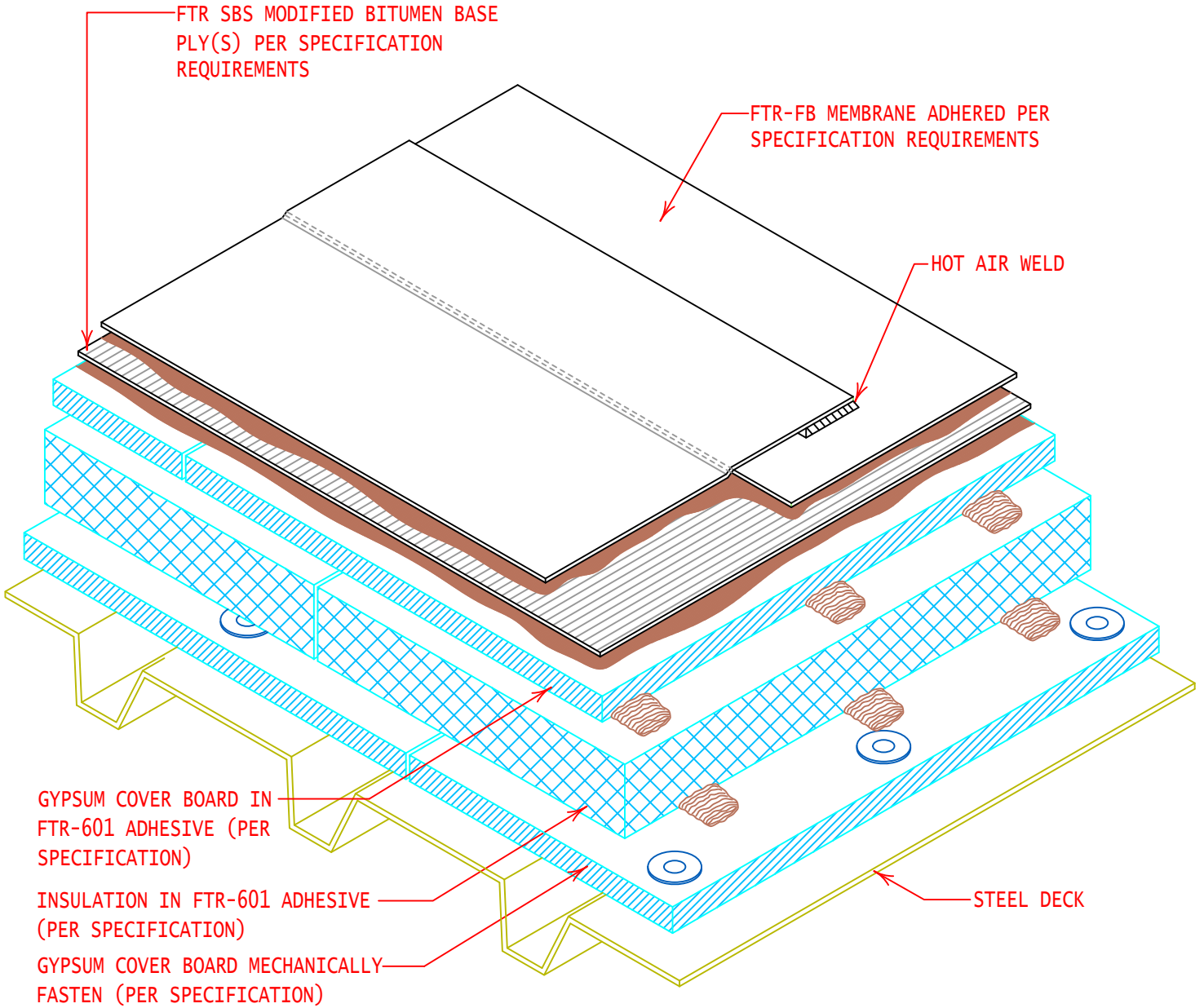

FTR SBS MODIFIED BITUMEN BASE  
 PLY(S) PER SPECIFICATION  
 REQUIREMENTS

FTR-FB MEMBRANE ADHERED PER  
 SPECIFICATION REQUIREMENTS

HOT AIR WELD

GYPSUM COVER BOARD IN  
 FTR-601 ADHESIVE (PER  
 SPECIFICATION)

INSULATION IN FTR-601 ADHESIVE  
 (PER SPECIFICATION)

GYPSUM COVER BOARD MECHANICALLY  
 FASTEN (PER SPECIFICATION)

STEEL DECK



GENERAL REFERENCE:  
 "FTR GS 01/21"

APPLICABLE SYSTEMS:  
 "FTR MP 01/21"

MULTI-PLY ROOF SYSTEM CROSS SECTION  
 (MECH. FAST. COVERBOARD & ADHERED INSULATION)

REVISES DETAIL

ALL PREVIOUS

ISSUE DATE

06-16-15

DRAWING NUMBER

FTR-DAS14MP