

NOTE:
 BOTTOM LAYER OF INSULATION SHALL BE LAID DOWN IN
 A STAGGERED PROFILE. STAGGER AND OFFSET TOP LAYER
 OF INSULATION FROM BOTTOM LAYER TO PREVENT
 ALIGNED EDGES.

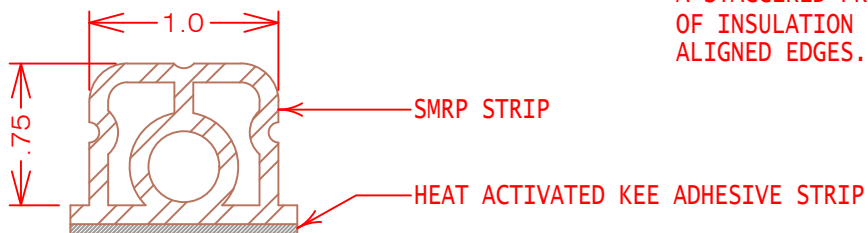

SMRP SECTION VIEW

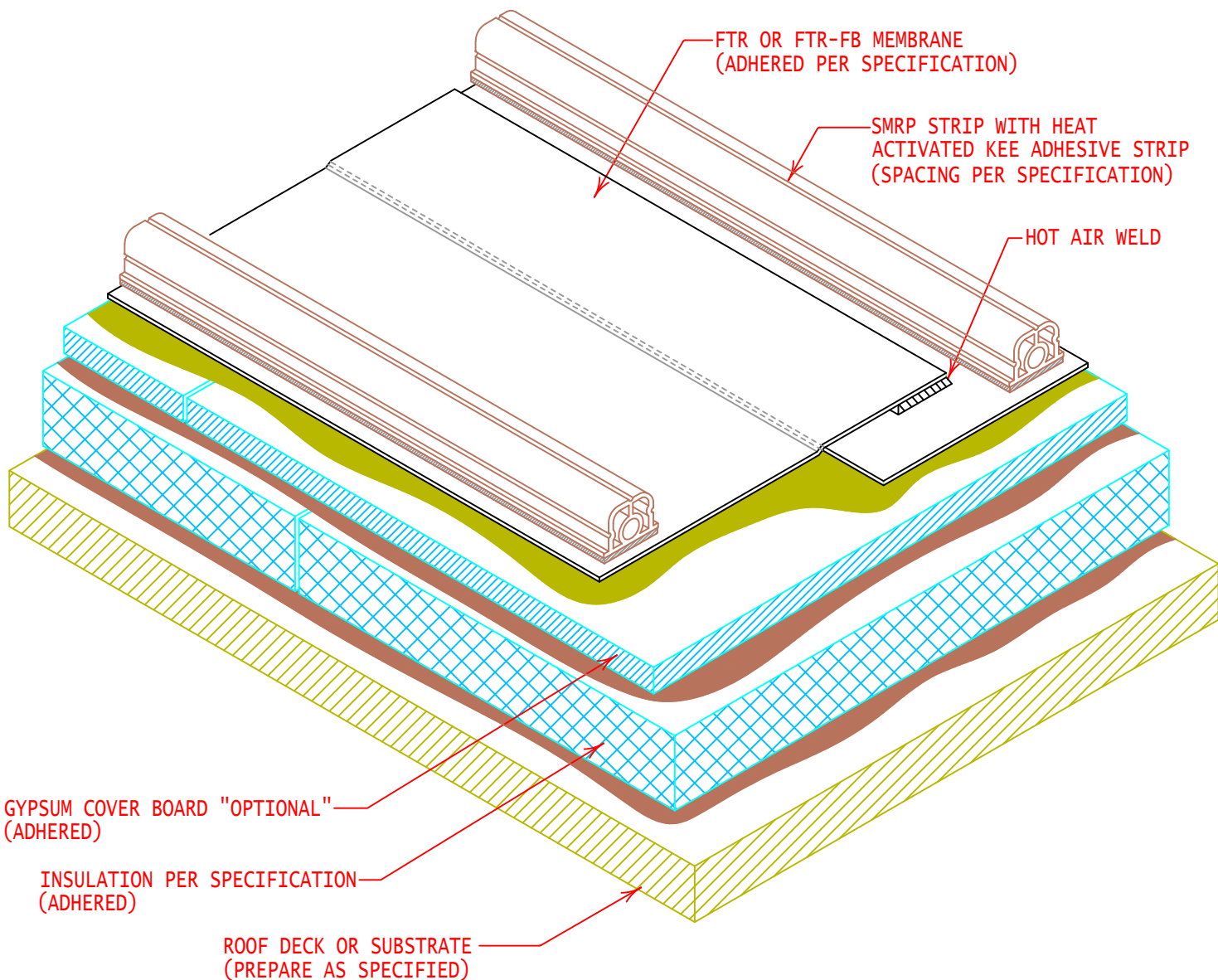

GYPSUM COVER BOARD "OPTIONAL"
 (ADHERED)

INSULATION PER SPECIFICATION
 (ADHERED)

ROOF DECK OR SUBSTRATE
 (PREPARE AS SPECIFIED)



GENERAL REFERENCE:
 "FTR GS 01/21"

APPLICABLE SYSTEMS:
 "FTR SMRP 01/21"

COMPOSITE ROOF SYSTEM CROSS SECTION
 ("SMRP" SIMULATED METAL ROOF PROFILE)

REVISES DETAIL
 ALL PREVIOUS

ISSUE DATE
 02-10-14

DRAWING NUMBER
 FTR-SMRP