

NON-LIFTABLE

FTR #101 SEALANT  
BEHIND TOP OF FLASHING

MECHANICAL UNIT

METAL COUNTERFLASHING, FASTEN W/  
EPDM WASHERED FASTENERS (12" O.C.)

FTR MEMBRANE FLASHING (FULLY ADHERED)

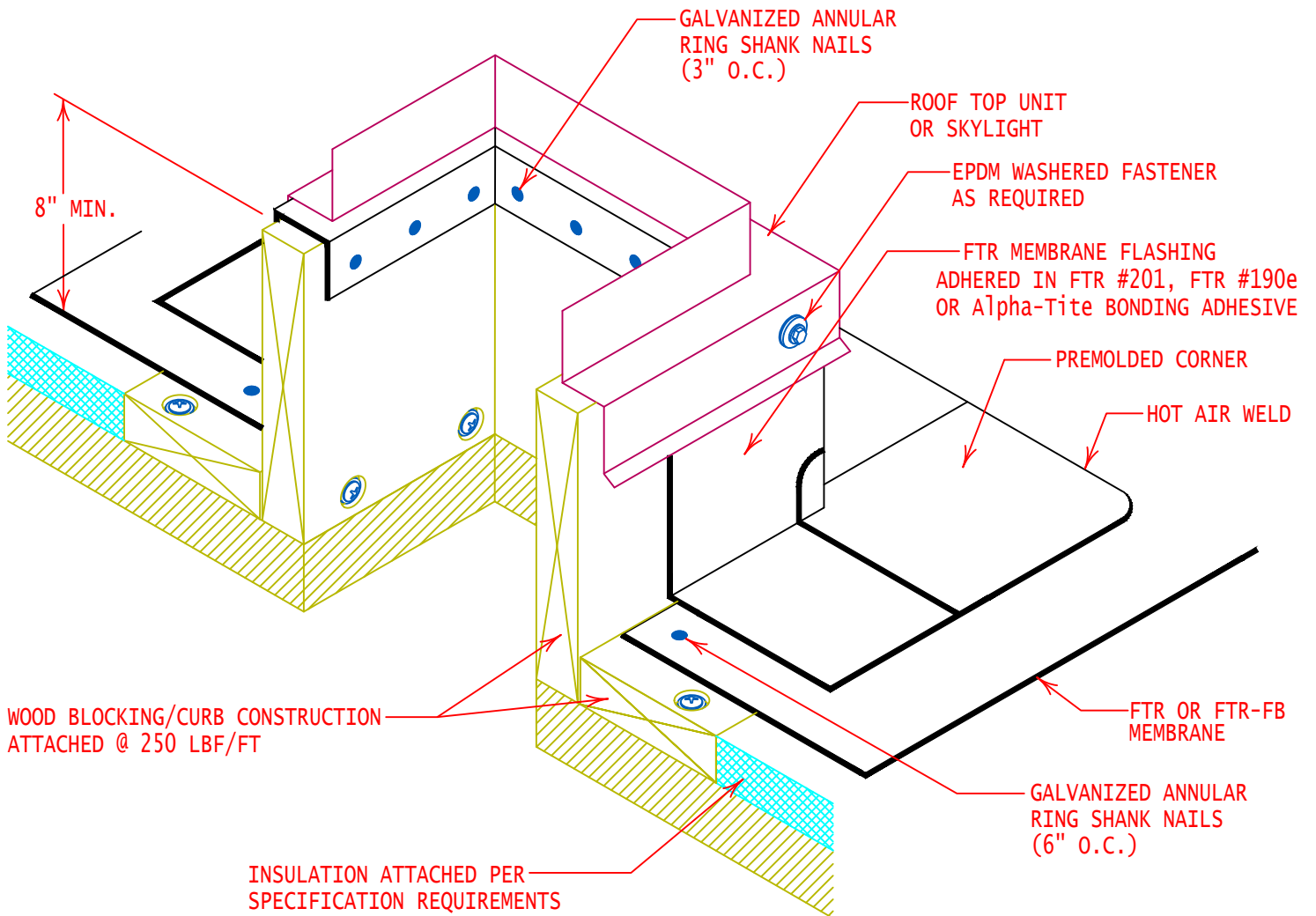

GENERAL REFERENCE:  
"FTR GS 01/21"  
APPLICABLE SYSTEMS:  
"FTR MA 01/21"  
"FTR AD 01/21"  
"FTR BA 01/21"

TYPICAL WOOD CURB OR SKYLIGHT FLASHING

REVISES DETAIL

ISSUE DATE

DRAWING NUMBER

ALL PREVIOUS

02-23-21

FTR-DP1i