

NOTE:
 BOTTOM LAYER OF INSULATION SHALL BE LAID DOWN IN
 A STAGGERED PROFILE. STAGGER AND OFFSET TOP LAYER
 OF INSULATION FROM BOTTOM LAYER TO PREVENT
 ALIGNED EDGES.

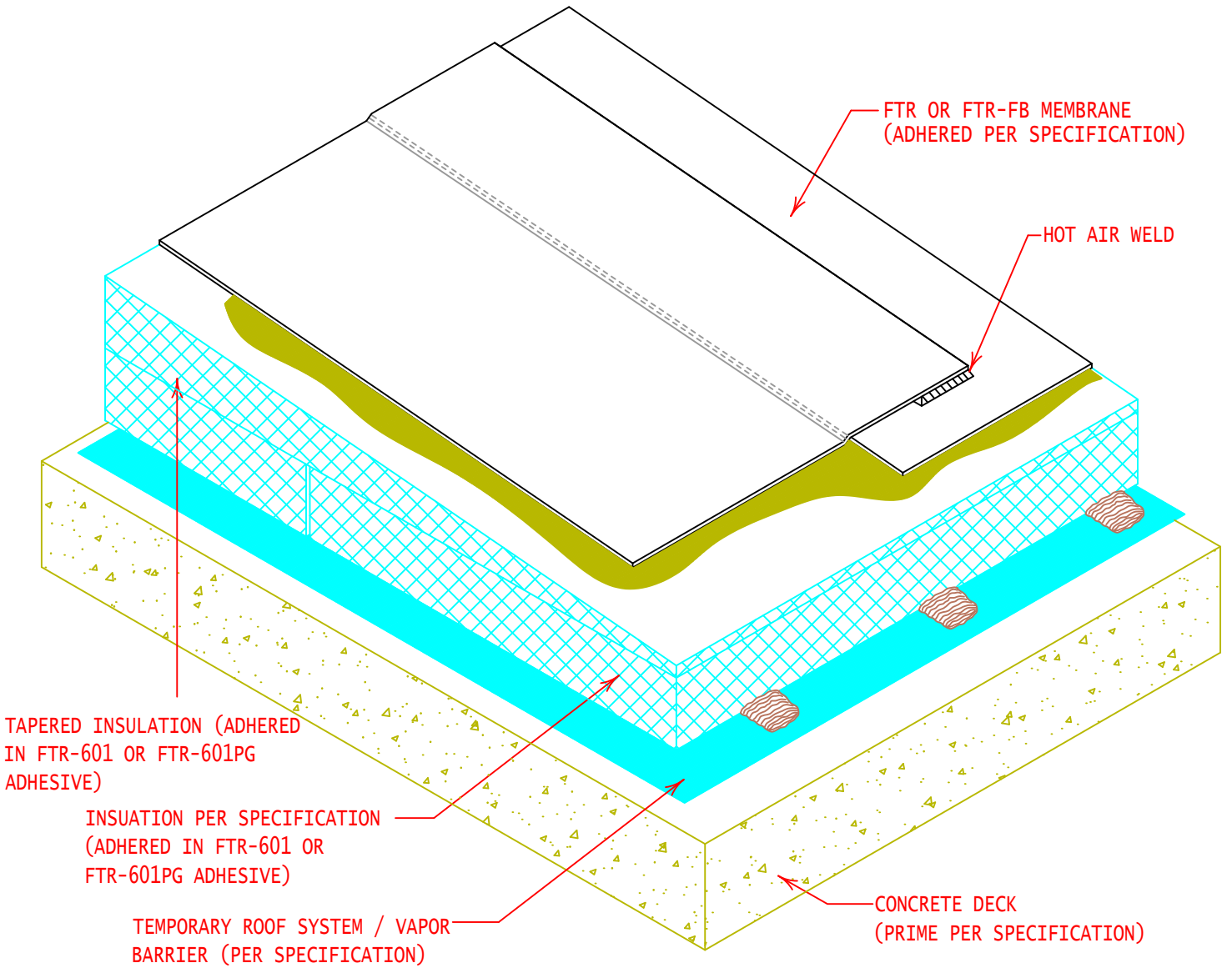

GENERAL REFERENCE:
 "FTR GS 01/21"
 APPLICABLE SYSTEMS:
 "FTR AD 01/21"

TAPERED ROOF SYSTEM CROSS SECTION
 WITH COVERBOARD

REVISES DETAIL
 ALL PREVIOUS

ISSUE DATE
 03-15-21

DRAWING NUMBER
 FTR-DAS2c