

NOTE:  
 BOTTOM LAYER OF INSULATION SHALL BE LAID DOWN IN  
 A STAGGERED PROFILE. STAGGER AND OFFSET TOP LAYER  
 OF INSULATION FROM BOTTOM LAYER TO PREVENT  
 ALIGNED EDGES.

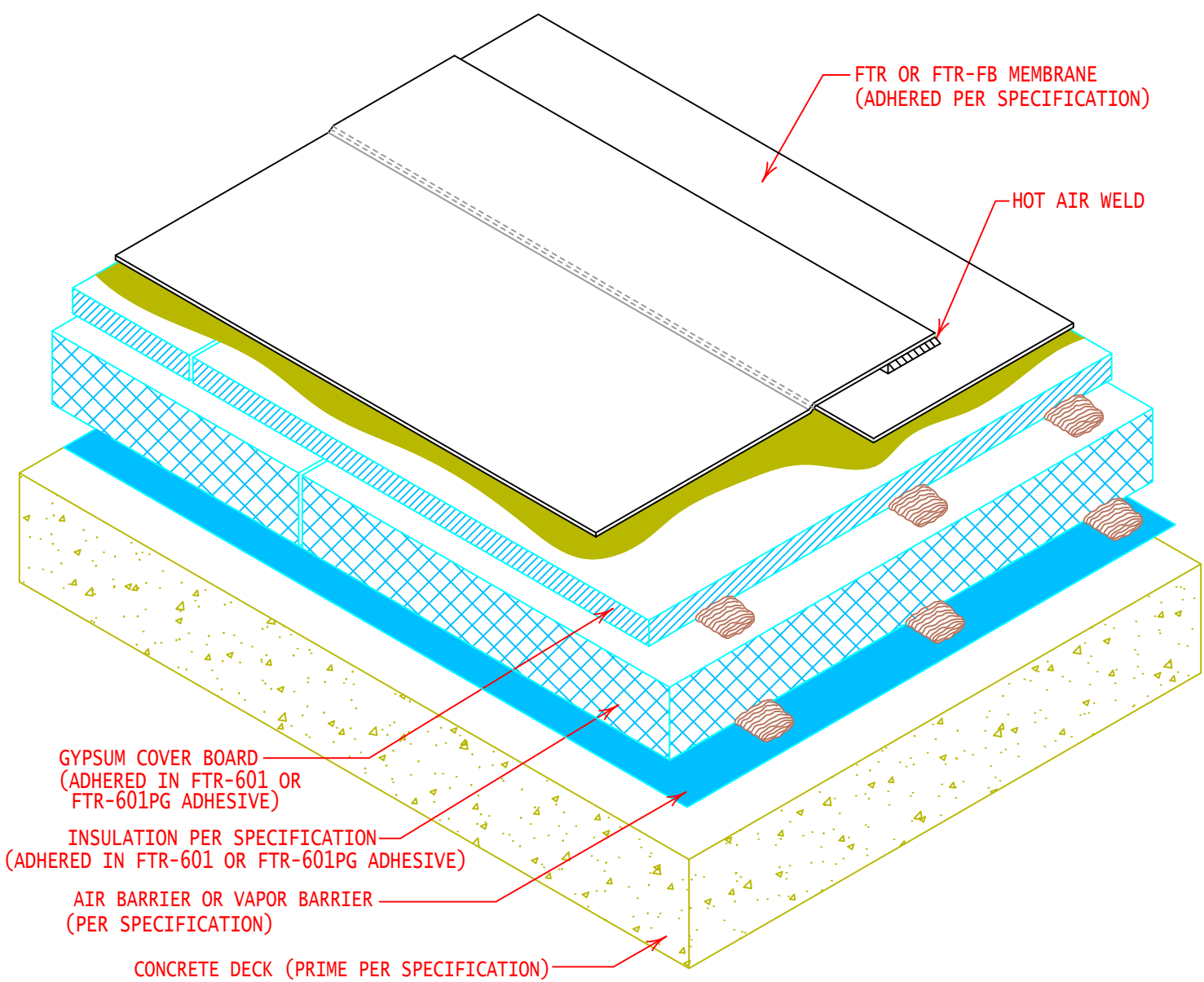

FTR OR FTR-FB MEMBRANE  
 (ADHERED PER SPECIFICATION)

HOT AIR WELD

GYPSUM COVER BOARD  
 (ADHERED IN FTR-601 OR  
 FTR-601PG ADHESIVE)

INSULATION PER SPECIFICATION  
 (ADHERED IN FTR-601 OR FTR-601PG ADHESIVE)

AIR BARRIER OR VAPOR BARRIER  
 (PER SPECIFICATION)

CONCRETE DECK (PRIME PER SPECIFICATION)



GENERAL REFERENCE:  
 "FTR GS 01/21"  
 APPLICABLE SYSTEMS:  
 "FTR AD 01/21"

COMPOSITE ROOF SYSTEM CROSS SECTION  
 W/ VAPOR BARRIER

REVISES DETAIL	ISSUE DATE	DRAWING NUMBER
ALL PREVIOUS	10-14-21	FTR-DAS2a