

NOTE:  
 BOTTOM LAYER OF INSULATION SHALL BE LAID DOWN IN  
 A STAGGERED PROFILE. STAGGER AND OFFSET TOP LAYER  
 OF INSULATION FROM BOTTOM LAYER TO PREVENT  
 ALIGNED EDGES.

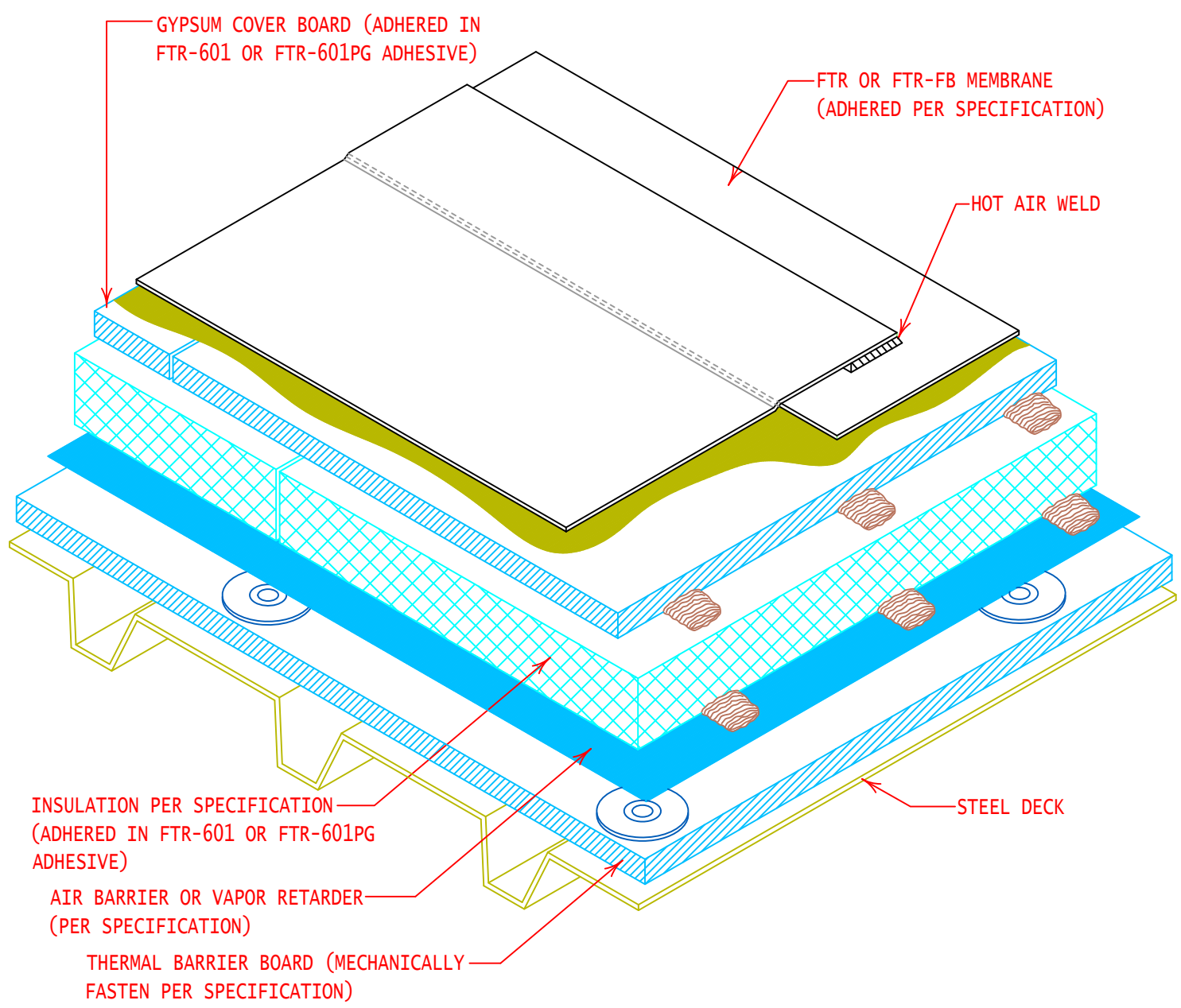

GENERAL REFERENCE:  
 "FTR GS 01/21"  
 APPLICABLE SYSTEMS:  
 "FTR AD 01/21"

COMPOSITE ROOF SYSTEM CROSS SECTION  
 (ADHERED INSULATION IN FTR-601 ADHESIVE)

REVISES DETAIL	ISSUE DATE	DRAWING NUMBER
ALL PREVIOUS	03-15-21	FTR-DAS10